

be

baumschlager eberle  
architekten



CAMERIMAGE EUROPEAN FILM CENTRE IN TORUŃ RENDERING JD 101

## Press information

Camerimage European Film Centre

Toruń, Poland

## Project description 1 | 3



CAMERIMAGE EUROPEAN FILM CENTRE IN TORUŃ RENDERING JD 116

## Competition for the Camerimage European Film Centre in Toruń, Poland A success for Baumschlager Eberle Architekten.

### Competition

Baumschlager Eberle Architekten recently won first prize in a two-stage competition for the **Camerimage European Film Centre** in Toruń, Poland. With a total of 42 participants in the first stage and five in the second, the competition was numerous and high-ranking. The second prize went to the Japanese firm Kengo Kuma with their partner K. Ingarden, J. Ewy Architekci Co.

The construction of the new film centre, the annual highlight of which is **a festival**, represents the largest investment in the cultural sector in Poland with construction costs of around € 120 million. The costs are largely borne by the Polish government and the city of Toruń. Completion is planned for 2025.

### Festival History-Development

1. The history of the festival started in Toruń. The festival was there between 1993-1999
2. The next edition took place in Łódź where the festival stayed for ten years: 2000-2009. At that time, the first endeavours were made to build the festival and conference centre with the film studio. The project was created by Frank Gehry, but the government at the time didn't want to support the festival with the public money. In 2010, the festival organizers decided to move the festival out of Łódź.
3. The 2010 edition of the festival was organized in Bydgoszcz, where it stayed until 2018.
4. In December 2017, Minister of Culture Piotr Gliński, President of Toruń Michał Zaleski and Mr Marek Żydowicz signed the agreement to create the Festival Centre in Toruń. The festival has been in Toruń since 2019.

## Project description 2 | 3

### **Construction task: Importance for Poland**

National & International

There aren't many places in Poland where a world-class cultural event comparable to Cannes or the Oscars could take place. Due to the annual film festival, Toruń was proposed for it. The Camerimage Centre with its festival hall and the accompanying infrastructure for film production and screening is definitely a step in this direction. The Camerimage Film Centre has the potential to be a place of promotion of Polish film and a place of lively cultural exchange with a global reach. For these reasons, the entire project is co-financed by the Polish government. In contrast to the prominent festivals with their celebrity image, the festival in Toruń focuses on the people involved in the production side of filmmaking.

Especially for camera women and men, the award of the "Golden Frog" as a counterpart to the Oscar is an indicator of the quality of their work. The new Camerimage Centre is symbolically guarded by a mighty "Golden Frog", who appears in the legends of the city on the Vistula.

In the immediate vicinity of the Camerimage Centre is the Jordanki Culture and Congress Centre, designed by Fernando Menis. The existing and future ensemble will enrich the planning area as a „cultural district“ with a new quality as an architectural and public space.

Toruń, a city west of Warsaw with a population of around 200,000 and a wonderful historical legacy from the Middle Ages, is preparing for its future as the country's cultural hotspot.

### **Construction task: Importance for our office**

National & International

After the two music centres in Lusławice and Krakow from our office be ddjm Krakow, the film centre is another **contribution** in the field of architecture for cultural buildings. The project was created in cooperation between the offices in Lustenau and Krakow.

For Baumschlager Eberle, the dimension of the new project also counts. With construction costs of around € 120 million and around 41.165 square meters of gross floor area, it represents a quantum leap: Far beyond the borders of Poland, it is Baumschlager Eberle's first construction project of this size in the cultural sector. Our Krakow office be ddjm Kraków has gained experience and competence over the years. The most recent projects include the music centres in Lusławice (completed) and Krakow (in planning), which have cemented reputation of Baumschlager Eberle Architekten in the cultural sector in Poland.

In other typologies - for example in administrative buildings - Baumschlager Eberle Architekten have already been able to develop a considerable number of buildings of a similar size over the years.

The project is linked to a very important world-class cultural event: the **Camerimage Festival** - this means that every year the building will be the backdrop for a major international media event. As a hub of the film industry, the festival opens up the possibility of increasing awareness of the Baumschlager Eberle Architekten brand worldwide.

### **Architecture**

Harmoniously integrated into the city's green belt, the new building composition complements the historic city centre of Toruń. This makes the project a natural part of the city and a new highlight for the future. In concrete terms, the future means that a film studio, a training centre, the actual festival hall, a presentation forum for the film industry, cinemas and an underground film museum will be built here in stages.

## Project description 3|3

Thematically, the crystalline part of the architecture represents the finishing touch of nature. The buildings symbolize six "stones in the park" in order to achieve the union of nature and architecture. The crystalline architecture also means openness and unity, with a view of the city and comfort in the dark of the cinema halls. The choice of materials is also appropriate: glass and coloured metal form a high-contrast surface for the building, the significant geometry of which characterizes the specific location.

The film centre is ambivalent in its use: It functions as a green outdoor space for the population, it is used in everyday life and is a meeting place for international filmmakers once a year.

**Prof. Dietmar Eberle** said: *„The project reflects our fundamental approach to designing architecture for everyday life. In an authentic way, a high practical value is brought into harmony with the poetic interpretation of the location and the added cultural value of the building.“*

As a future user, **Marek Żydowicz, Director of the Camerimage European Film Centre**, characterizes the importance of the project from his point of view: *„It is the building that will be in public ownership. It will function 365 days a year and will not serve only the needs of the festival, but it will have a year-round program, not only in terms of film screenings, but also exhibitions. There will also be commercial activities related to the market and an education center. This building will be the first place in Poland where world premiere events can be held. Therefore, it must be a unique building“.*

The **competition jury** justified its decision in favour of the Baumschlager Eberle Architekten project with the fulfilment of all requirements for a multi-layered functional program and the importance for the city of Toruń: ***The concept of the multifunctional common rooms fits harmoniously into the desired typology of the scattered buildings. This enables an appropriate spatial relationship to the fairground and the park. The dynamic shapes of the buildings offer the opportunity to create a distinctive, modern landmark in Toruń.***

### Phasing

One of the great advantages of the Baumschlager Eberle Architekten project is the possibility of completing the project in stages. The building plan includes a film studio, the learning centre, the "shop" as a presentation centre for the film industry as well as the large festival hall, the cinema centre and the underground film museum.

On the basis of winning the competition, Baumschlager Eberle Architekten are negotiating further cooperation with the public sector and the Camerimage Centre. The completion of the ensemble is expected in 2025.

### The design team at Baumschlager Eberle Architekten

Prof. Dietmar Eberle, Hugo Herrera Pianno, Mateusz Dudek, Melanie Ghanem, Johannes Burtscher, Maria José Rodriguez de Vera Guardiola, Agnieszka Miecznikowska, Aleksandra Śliwa, Gabriela Kasperkiewicz.

## Facts and figures



CAMERIMAGE EUROPEAN FILM CENTRE IN TORUŃ RENDERING JD 103



CAMERIMAGE EUROPEAN FILM CENTRE IN TORUŃ RENDERING JD 104

### **Camerimage European Film Centre**

Toruń, Poland

#### **A city for cinema lovers**

From teaching production to the festival: The European Film Center Camerimage will become the focus for cinema lovers in Torun, Poland. Baumschlager Eberle Architects have combined the complex functions into six structures. Their crystalline form is in dialogue with the surrounding green of the park close to the center.

**Typology** Mixed use - Film studio, training centre, exhibition space, festival centre, cinemas, museum

**Client** Camerimage Centre, Poland

**Site** Aleja Solidarności, Toruń, Poland

**Site area** 24,000 m<sup>2</sup>

**Building floor area** 357 m<sup>2</sup>

**Gross floor area** 41,165 m<sup>2</sup>

**Completion** scheduled for 2025

**Renderings** Jan Drška

**Team** Baumschlager Eberle Architekten, Lustenau (AT) and Kraków (PL)

#### **Photographic material requirements**

The images in this pack are available free of charge for use in reporting on the *Camerimage European Film Centre*.

For high-resolution images for print or web, please get in touch with our press department. You will find the relevant details in the press contacts section at the end of this press information.

## Press photos

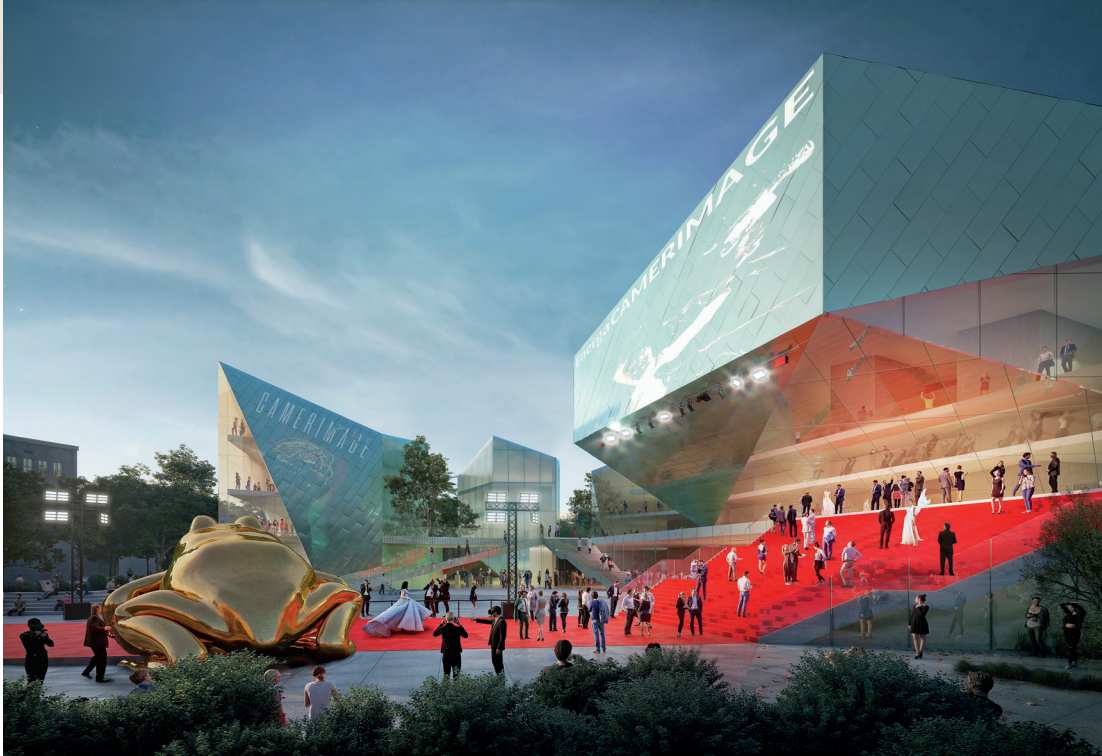

CAMERIMAGE EUROPEAN FILM CENTRE IN TORUŃ RENDERING JD 110



CAMERIMAGE EUROPEAN FILM CENTRE IN TORUŃ RENDERING JD 112



CAMERIMAGE EUROPEAN FILM CENTRE IN TORUŃ RENDERING JD 114



CAMERIMAGE EUROPEAN FILM CENTRE IN TORUŃ RENDERING D 115

# Baumschlager Eberle Architekten



## Profile

### The practice

Baumschlager Eberle Architekten uses a clear, systematic approach to design and build landmark structures worldwide. Founded in Austria's Vorarlberg in 1985, with eleven offices in Europe and Asia, we are now a major architecture firm.

## Portfolio

### What we do

Alongside our main focus on residential and office developments, we also work in the fields of education and culture, health and sport, transport and traffic and are active in the wider planning environment, managing both interior and landscape design projects. Today we have completed some 500 projects in 20 countries spanning three continents.

## Process

### How we work

During the design and planning process we examine every aspect of a building project in all its complexity. This work forms the basis for clear and logical decision making, ensures quality throughout the construction process and guarantees transparency and trust.

## Offices

### Where we work

#### A local presence around the globe

We have a firm footing in both Europe and Asia with eleven offices located in a number of cities. Our presence on the ground broadens our understanding of local conditions and cultural specificities and helps us stay close to our clients.

## Team

### As international as our clients

We see ourselves as team players, a group of highly qualified professionals planning and implementing projects with character and passion. The team currently consists of around 270 staff members from 21 countries who communicate in 19 different languages.

## Sustainability

### Our contribution

Longevity is the major contribution a building can make in terms of ecology, economy and cultural value. With this in mind, we construct our buildings to meet a raft of sustainability criteria relating to resources and energy, quality and neutrality of use.

## Press contacts



CAMERIMAGE EUROPEAN FILM CENTRE IN TORUŃ RENDERING JD 105



CAMERIMAGE EUROPEAN FILM CENTRE IN TORUŃ RENDERING JD 102

### **Claudia Schwind**

7, rue Debelleyme | 75003 Paris France  
+33 7 85 46 51 02  
c.schwind@be-architects.fr  
Languages DE | EN | FR | IT

### **Gert Walden**

Praterstrasse 33/5 | 1020 Vienna Austria  
+43 676 394 26 63  
g.walden@be-wien.com  
Languages DE | EN

### **Copyright project**

Baumschlager Eberle Architekten

### **Baumschlager Eberle Architekten**

Baumschlager Eberle Architekten is a member of :be AG, a group whose parent company specialises in investments in architecture firms across Europe and Asia. Its 16 subsidiaries are highly professional architectural design practices with over 35 years' commercial experience. They work with clear processes to the highest architectural standards and are motivated by a strong creative and innovative drive. Operating under the Baumschlager Eberle Architekten name, they have carved out a place for themselves in the world of architecture through award-winning buildings that are both highly efficient and internationally renowned. :be AG's 2226 building concept gives the group a unique selling point in the sustainability sector.

© 2021 be architects holding AG



**be**  
baumschlager eberle  
architekten



[www.baumschlager-eberle.com](http://www.baumschlager-eberle.com)